

TABLE OF CONTENTS

Injection	2
------------------------	----------

INJECTION

Injection

9 OZ. - HOT CUP (IA 009A)



Group :	Injection
Type :	Hot Cup
Model Code :	IA 009A
Material :	PP
Color :	White
Size :	9 oz.
Dimension (mm) :	Dia 81.00 x H 85.00
Packing / Ctn. :	200
Carton Size :	175 x 415 x 480 mm. (0.035 Cbm.)

[Read More](#)



885 ML. - ROUND MICROWAVEABLE (IM 031A)

Group :	Injection
Type :	Microwaveable
Model Code :	IM 031A
Material :	PP
Color :	White
Size :	855 ml.
Dimension (mm) :	Dia 155.00 x H 68.80
Packing / Ctn. :	150
Carton Size :	330 x 490 x 570 mm. (0.092 Cbm.)



[Read More](#)



80 G. - YOGURT CUP (IY 004C)

Group :	Injection
Type :	Yogurt Cup
Model Code :	IY 004C
Material :	PP
Color :	White
Size :	80 g.
Dimension (mm) :	Dia 71.50 x H 53.00
Packing / Ctn. :	1,000
Carton Size :	305 x 360 x 470 mm. (0.052Cbm.)



[Read More](#)



80 G. - YOGURT CUP (IY 004A)

Group :	Injection
Type :	Yogurt Cup
Model Code :	IY 004A
Material :	PP
Color :	White
Size :	80 g.
Dimension (mm) :	Dia 71.50 x H 48
Packing / Ctn. :	1,000
Carton Size :	375 x 595 x 285 mm. (0.064 Cbm.)



[Read More](#)



80 G. - YOGURT CUP NEW DESIGN (IY 004D)

Group :	Injection
Type :	Yogurt Cup
Model Code :	IY 004D
Material :	PP
Color :	White
Size :	80 g.
Dimension (mm) :	Dia 71.50 x H 48
Packing / Ctn. :	1,000
Carton Size :	315 x 390 x 485 mm. (0.060 Cbm.)



[Read More](#)



7 OZ. - ROUND MICROWAVEABLE (IM 007A)

Group :	Injection
Type :	Microwaveable
Model Code :	IM 007A
Material :	PP
Color :	White, Clear
Size :	7 oz.
Dimension (mm) :	Dia 88.00 x H 51.00
Packing / Ctn. :	1,000
Carton Size :	455 x 455 x 390 mm. (0.081 Cbm.)

[Read More](#)



680 ML. - ROUND MICROWAVEABLE (IM 017A)

Group :	Injection
Type :	Microwaveable
Model Code :	IM 017A
Material :	PP
Color :	White
Size :	680 ml.
Dimension (mm) :	Dia 143.80 x H 68.80
Packing / Ctn. :	400
Carton Size :	305 x 600 x 360 mm. (0.066 Cbm.)

[Read More](#)



650 ML. - RECTANGULAR MICROWAVEABLE (IT 024A)

Group :	Injection
Type :	Microwaveable
Model Code :	IT 024A
Material :	PP
Color :	Black
Size :	650 ml.
Dimension (mm) :	123.43 x 175.00 x 48.25
Packing / Ctn. :	300
Carton Size :	375 x 375 x 260 mm. (0.037 Cbm.)



[Read More](#)



650 ML. - RECTANGULAR MICROWAVEABLE

Group :	Injection
Type :	Microwaveable
Model Code :	-
Material :	PP
Color :	White
Size :	650 ml.
Dimension (mm) :	123.43 x 175.00 x 48.25
Packing / Ctn. :	300
Carton Size :	375 x 375 x 260 mm. (0.037 Cbm.)



[Read More](#)



64 OZ. - PP BUCKET + HANDLE + LID (IB 064A)

Group :	Injection
Type :	Bucket
Model Code :	IB 064A
Material :	PP
Color :	White
Size :	64 oz.
Dimension (mm) :	Dia 162.00 x H 120.00
Packing / Ctn. :	100 SETS
Carton Size :	327 x 375 x 730 mm. (0.090 Cbm.)



[Read More](#)

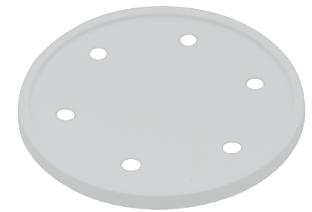

630 ML. - ROUND MICROWAVEABLE (IM 031B)

Group :	Injection
Type :	Microwaveable
Model Code :	IM 031B
Material :	PP
Color :	White
Size :	630 ml.
Dimension (mm) :	Dia 155.00 x H 68.80
Packing / Ctn. :	300
Carton Size :	330 x 490 x 570 mm. (0.092 Cbm.)



[Read More](#)



500 ML. - SQUARE MICROWAVEABLE (IT 018B)

Group :	Injection
Type :	Microwaveable
Model Code :	IT 018B
Material :	PP
Color :	White
Size :	500 ml.
Dimension (mm) :	126.00 x 126.00 x 51.00
Packing / Ctn. :	500
Carton Size :	270 x 650 x 450 mm. (0.079 Cbm.)



[Read More](#)



45 OZ. - PP BUCKET + HANDLE + LID (IB 045A)



Group :	Injection
Type :	Bucket
Model Code :	IB 045A
Material :	PP
Color :	White
Size :	45 oz.
Dimension (mm) :	Dia 140.00 x H 122.00
Packing / Ctn. :	100 SETS
Carton Size :	280 x 420 x 605 mm. (0.071 Cbm.)

[Read More](#)

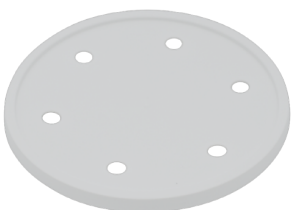

45 OZ. - PP BUCKET + HANDLE (IB 045A)

Group :	Injection
Type :	Bucket
Model Code :	IB 045A
Material :	PP
Color :	White
Size :	45 oz.
Dimension (mm) :	Dia 140.00 x H 122.00
Packing / Ctn. :	100 SETS
Carton Size :	310 x 310 x 625 mm. (0.060 Cbm.)



[Read More](#)



44 OZ. TRAVELER - COLD CUP (IC 044B)

Group :	Injection
Type :	Cold Cup
Model Code :	IC 044B
Material :	PP
Color :	White
Size :	44 oz.
Dimension (mm) :	Dia 114.00 x H 202.00
Packing / Ctn. :	500
Carton Size :	480 x 580 x 525 mm. (0.146 Cbm.)

[Read More](#)



425 ML. - ROUND MICROWAVEABLE (IM 015A)

Group :	Injection
Type :	Microwaveable
Model Code :	IM 015A
Material :	PP
Color :	White
Size :	425 ml.
Dimension (mm) :	Dia 117.50 x H 67.63
Packing / Ctn. :	700
Carton Size :	490 x 615 x 440 mm. (0.133 Cbm.)



[Read More](#)



4 OZ. - ROUND MICROWAVEABLE (IM 004A)

Group :	Injection
Type :	Microwaveable
Model Code :	IM 004A
Material :	PP
Color :	Clear
Size :	4 oz.
Dimension (mm) :	Dia 75.00 x H 44.00
Packing / Ctn. :	500
Carton Size :	155 x 380 x 380 mm. (0.022 Cbm.)



[Read More](#)



32 OZ. TRAVELER - COLD CUP (IC 032B)

Group :	Injection
Type :	Cold Cup
Model Code :	IC 032B
Material :	PP
Color :	White
Size :	32 oz.
Dimension (mm) :	Dia 107.00 x H 180.00
Packing / Ctn. :	500
Carton Size :	540 x 540 x 560 mm. (0.163 Cbm.)

[Read More](#)



22 OZ. - COLD CUP WITH LEGS (IC 022A)



Group :	Injection
Type :	Cold Cup
Model Code :	IC 022A
Material :	PP
Color :	White
Size :	22 oz.
Dimension (mm) :	Dia 90.00 x H 170.00
Packing / Ctn. :	500
Carton Size :	365 x 455 x 470 mm. (0.078 Cbm.)

[Read More](#)



22 OZ. - COLD CUP FLAT BOTTOM (IC 022B)

Group :	Injection
Type :	Cold Cup
Model Code :	IC 022B
Material :	PP
Color :	Clear
Size :	22 oz.
Dimension (mm) :	Dia 90.00 x H 160.00
Packing / Ctn. :	500
Carton Size :	365 x 455 x 450 mm. (0.075 Cbm.)



[Read More](#)



20 OZ. - ROUND MICROWAVEABLE (IM 020A)

Group :	Injection
Type :	Microwaveable
Model Code :	IM 020A
Material :	PP
Color :	White
Size :	20 oz.
Dimension (mm) :	Dia 118.00 x H 85.00
Packing / Ctn. :	500
Carton Size :	475 x 595 x 310 mm. (0.088 Cbm.)



[Read More](#)



20 OZ. - ICE CREAM CUP (IM 020A)

Group :	Injection
Type :	Ice Cream Cup
Model Code :	IM 020A
Material :	PP
Color :	Clear
Size :	20 oz.
Dimension (mm) :	Dia 118.00 x H 85.00
Packing / Ctn. :	500
Carton Size :	475 x 595 x 310 mm. (0.088 Cbm.)



[Read More](#)



18 OZ. - NOODLE CUP (IN 018A)

Group :	Injection
Type :	Noodle Cup
Model Code :	IN 018A
Material :	PP
Color :	White
Size :	18 oz.
Dimension (mm) :	Dia 95.00 x H 113.10
Packing / Ctn. :	250
Carton Size :	485 x 485 x 390 mm. (0.092 Cbm.)



[Read More](#)



17 OZ. - NOODLE CUP (IN 017B)

Group :	Injection
Type :	Noodle Cup
Model Code :	IN 017B
Material :	PP
Color :	White
Size :	17 oz.
Dimension (mm) :	Dia 94.50 x H 112.00
Packing / Ctn. :	198
Carton Size :	305 x 580 x 365 mm. (0.065 Cbm.)



[Read More](#)



16 OZ. - ROUND MICROWAVEABLE (IM 016A)

Group :	Injection
Type :	Microwaveable
Model Code :	IM 016A
Material :	PP
Color :	White
Size :	16 oz.
Dimension (mm) :	Dia 118.00 x H 64.00
Packing / Ctn. :	500
Carton Size :	500 x 595 x 290 mm. (0.086 Cbm.)



[Read More](#)



16 OZ. - ICE CREAM CUP (IM 016A)

Group :	Injection
Type :	Ice Cream Cup
Model Code :	IM 016A
Material :	PP
Color :	Clear
Size :	16 oz.
Dimension (mm) :	Dia 118.00 x H 64.00
Packing / Ctn. :	500
Carton Size :	500 x 595 x 290 mm. (0.086 Cbm.)



[Read More](#)



16 OZ. - COLD CUP (IC 016C)

Group :	Injection
Type :	Cold Cup
Model Code :	IC 016C
Material :	PP
Color :	White, Clear
Size :	16 oz.
Dimension (mm) :	Dia 90.00 x H 130.00
Packing / Ctn. :	500
Carton Size :	185 x 455 x 570 mm. (0.048 Cbm.)



[Read More](#)



157 OZ. - PP BUCKET LOW STACK + LID (IB 157B)

Group :	Injection
Type :	Bucket
Model Code :	IB 157B
Material :	PP
Color :	White
Size :	157 oz.
Dimension (mm) :	Dia 210.00 x H 157.00
Packing / Ctn. :	50 SETS
Carton Size :	230 x 440 x 590 mm. (0.110 Cbm.)



[Read More](#)



157 OZ. - PP BUCKET + LID (IB 157A)

Group :	Injection
Type :	Bucket
Model Code :	IB 157A
Material :	PP
Color :	Clear
Size :	157 oz.
Dimension (mm) :	Dia 210.00 x H 156.00
Packing / Ctn. :	50 SETS
Carton Size :	430 x 640 x 400 mm. (0.110 Cbm.)



[Read More](#)

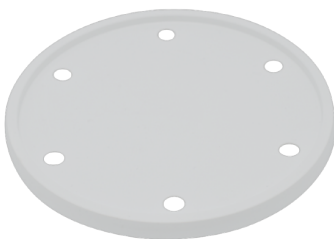

140 G. - YOGURT CUP (IY 006E)

Group :	Injection
Type :	Yogurt Cup
Model Code :	IY 006E
Material :	PP
Color :	White
Size :	140 oz.
Dimension (mm) :	Dia 71.50 x H 82.00
Packing / Ctn. :	1,000
Carton Size :	305 x 360 x 520 mm. (0.037 Cbm.)



[Read More](#)



140 G. - YOGURT CUP (IY 006D)

Group :	Injection
Type :	Yogurt Cup
Model Code :	IY 006D
Material :	PP
Color :	White
Size :	140 oz.
Dimension (mm) :	Dia 71.50 x H 82.00
Packing / Ctn. :	1,000
Carton Size :	305 x 360 x 520 mm. (0.037 Cbm.)



[Read More](#)



140 G. - YOGURT CUP (IY 006A)

Group :	Injection
Type :	Yogurt Cup
Model Code :	IY 006A
Material :	PP
Color :	White
Size :	140 oz.
Dimension (mm) :	Dia 71.50 x H 82.00
Packing / Ctn. :	1,000
Carton Size :	305 x 360 x 660 mm. (0.072 Cbm.)



[Read More](#)



135 G. - YOGURT CUP IML NEW DESIGN (IY 006G)



Group :	Injection
Type :	Yogurt Cup
Model Code :	IY 006G
Material :	PP
Color :	White
Size :	135 g.
Dimension (mm) :	Dia 71.50 x H 82.00
Packing / Ctn. :	1,000
Carton Size :	305 x 360 x 590 mm. (0.065 Cbm.)

[Read More](#)



13 OZ. - ROUND MICROWAVEABLE (IM 013A)

Group :	Injection
Type :	Microwaveable
Model Code :	IM 013A
Material :	PP
Color :	White
Size :	13 oz.
Dimension (mm) :	Dia 118.00 x H 58.00
Packing / Ctn. :	500
Carton Size :	600 x 480 x 260 mm. (0.075 Cbm.)

[Read More](#)



125 G. - YOGURT CUP (IY 006B)



Group :	Injection
Type :	Yogurt Cup
Model Code :	IY 006B
Material :	PP
Color :	White
Size :	125 g.
Dimension (mm) :	Dia 71.50 x H 82.00
Packing / Ctn. :	1,000
Carton Size :	305 x 360 x 660 mm. (0.072 Cbm.)

[Read More](#)



12 OZ. - ROUND MICROWAVEABLE (IM 012A)

Group :	Injection
Type :	Microwaveable
Model Code :	IM 012A
Material :	PP
Color :	White
Size :	12 oz.
Dimension (mm) :	Dia 118.00 x H 47.00
Packing / Ctn. :	500
Carton Size :	500 x 595 x 290 mm. (0.086 Cbm.)



[Read More](#)



12 OZ. - COLD CUP (IC 012A)



Group :	Injection
Type :	Cold Cup
Model Code :	IC 012A
Material :	PP
Color :	Clear
Size :	12 oz.
Dimension (mm) :	Dia 80.00 x H 118.00
Packing / Ctn. :	500
Carton Size :	165 x 405 x 590 mm. (0.039 Cbm.)

[Read More](#)



110 G. - YOGURT CUP SLIM (IY 005C)

Group :	Injection
Type :	Yogurt Cup
Model Code :	IY 005C
Material :	PP
Color :	White
Size :	110 g.
Dimension (mm) :	Dia 71.50 x H 80.00
Packing / Ctn. :	500
Carton Size :	310 x 360 x 490 mm. (0.055 Cbm.)



[Read More](#)



110 G. - YOGURT CUP (IY 005A)

Group :	Injection
Type :	Yogurt Cup
Model Code :	IY 005A
Material :	PP
Color :	White
Size :	110 g.
Dimension (mm) :	75.00 x 95.00 x 47.00
Packing / Ctn. :	1,000
Carton Size :	405 x 405 x 425 mm. (0.070 Cbm.)



[Read More](#)

